

Sleepy Hollow WILDFIRE EVACUATION DRILL Sat, Aug 5, 2017 9am

All Sleepy Hollow residents are invited to participate. Residents of the following streets will receive emergency alerts and be asked to evacuate immediately to the Sleepy Hollow Community Center:

Butterfield Rd: 1317- 1500	Mather Rd Sulphur Spa Rd
Crane Dr	Tappan Ct
Dutch Valley Ln	Tappan Rd
Estates Dr	Tarry Rd
Garden Rock Rd	Triple C Ranch Rd
Greensburgh Ln	Van Ripper Ct
Ichabod Ct	Van Winkle Dr
Knickerbocker Ln	Whiteplains Ct
Manitou Dr	



Sleepy Hollow Fire Protection District
1040 Butterfield Rd
San Anselmo, CA 94960

**IMPORTANT! Sleepy Hollow
Evacuation Drill August 5**

Printed on Recycled Paper

August 5: Sleepy Hollow Evacuation Drill

Evacuation Drill August 5

Please plan to participate in Sleepy Hollow's first wildfire evacuation drill August 5, 2017. It's important that all Sleepy Hollow residents plan and prepare for an evacuation, and this drill provides an opportunity to practice and improve your planning.

Residents of northwest Sleepy Hollow will receive automated alerts by phone prior to the drill, exactly like they might during a real emergency. Law enforcement and firefighters will conduct training that day to exercise their plans for evacuation and fire suppression.

Evacuated residents should assemble at the Sleepy Hollow Community Center (1341 Butterfield Rd). All residents are invited to participate, with coffee, snacks, and a Safety Fair with information on wildfire and disaster preparedness from local agencies and organizations.

August 5, 2017

9AM

Reverse 9-1-1 and Alert Marin systems will notify residents of an immediate evacuation order.

9AM -11AM

Residents should evacuate immediately to a staging point at the Sleepy Hollow Community Center (1341 Butterfield Rd).

Firefighters and Law Enforcement will be conducting a live training exercise, so watch for heavy equipment, fire, and police vehicles.

Sleepy Hollow Fire Protection District EVACUATION Planning & Drill

Sleepy Hollow Wildfire Evacuation Drill: Aug 5, 2017

On August 5, 2017, SHFPD, Ross Valley Fire Department, Marin County Sheriff's Office, FIRESafe MARIN, and SHHA will host an evacuation drill for certain neighborhoods in Sleepy Hollow (all residents are welcome to participate).

Residents will receive an emergency notification by phone with instructions to evacuate to a rallying point at the Sleepy Hollow Community Center, where we'll have a safety fair with information and demonstrations on wildfire safety and evacuation tips.

TIP: you'll receive alerts by cell phone, text, or email only if you've previously enrolled your number(s) online at www.AlertMarin.org

Please plan to participate - use the opportunity to inform your family and prepare for the eventuality that a wildfire will strike in Sleepy Hollow!

Ross Valley Fire Department, along with other local fire and law enforcement agencies, will use this as a valuable training opportunity for both residents and emergency responders. Your participation will help make this a success, and help make Sleepy Hollow a Firewise Community!



Inside

Evacuation Checklist **P.1**

Evacuation Map **Inset**

Evacuation Planning **Inset**

Sleepy Hollow Evacuation Drill **P.4**

INSIDE: Sleepy Hollow Evacuation Map

Pre-Evacuation Checklist: Wildfire

When an evacuation is anticipated, follow these checklists (if time allows) to give your home the best chance of surviving a wildfire.

Inside the House

- Shut all windows and doors, leaving them unlocked.
- Remove flammable window shades, curtains and close metal shutters.
- Remove lightweight curtains.
- Move flammable furniture to the center of the room, away from windows and doors.
- Shut off gas at the meter; turn off pilot lights.
- Leave your lights on so firefighters can see your house under smoky conditions.
- Shut off the air conditioning.

Outside

- Gather up flammable items from the exterior of the house and bring them inside (patio furniture, children's toys, door mats, trash cans, etc.) or place them in your pool.
- Turn off propane tanks.
- Move propane BBQ appliances away from structures.
- Connect garden hoses to outside water valves or spigots for use by firefighters. Fill water buckets and place them around the house.

- Don't leave sprinklers on or water running, they can affect critical water pressure.
- Leave exterior lights on so your home is visible to firefighters in the smoke or darkness of night.
- Put your Emergency Supply Kit in your vehicle.
- Back your car into the driveway with vehicle loaded and all doors and windows closed.
- Carry your car keys with you.
- Have a ladder available and place it at the corner of the house for firefighters to quickly access your roof.
- Seal attic and ground vents with pre-cut plywood or commercial seals.
- Patrol your property and monitor the fire situation. Don't wait for an evacuation order if you feel threatened.
- Check on neighbors and make sure they are preparing to leave.

Animals

- Locate your pets and keep them nearby.
- Prepare horses and large animals for transport and think about moving them to a safe location early, before evacuation is ordered.

LEARN MORE ON THE WEB
We offer more details on the web.
Visit us at www.shfpd.org/firewise



Your Participation on Aug 5 is Vital

Sleepy Hollow is at risk of wildfire! Your participation in the August 5 Evacuation Drill is important to help our community prepare and test our plans!

Evacuation Tips: www.FireSafeMarin.org/ready-set-go

Are you ready?

Evacuation Preparedness



Prepare to Evacuate

Take responsibility and prepare long before a wildfire strikes. Create defensible space and use fire-resistant landscaping and construction. Assemble an emergency supply kit and belongings in a safe place at the start of fire season. Plan escape routes and make sure your whole family knows the plan.



During a Wildfire

Place your kit and belongings in your car whenever a fire is nearby. Gather your pets in carriers, and prepare your home: unlock doors, close blinds, turn on all lights. Follow evacuation instructions from law enforcement or firefighters IMMEDIATELY.



After a Wildfire

Return home only when emergency officials say it is safe.

Learn More Online

www.FireSafeMarin.org/ready-set-go

The Importance of Roadway Clearance

Parked cars and overgrown vegetation are not just a nuisance. Passable roadways free of vegetation can make the difference between life and death during a wildfire. Fire engines need 15' of overhead clearance, and vegetation on the sides of roads or illegally parked cars can block firefighters and impede your escape. Help us keep roads clear by cutting vegetation near roads and driveways on your property, and parking your cars well off the road.



Sleepy Hollow Wildfire Evacuation Routes

All residents - evacuate downhill, towards Butterfield Rd and San Anselmo

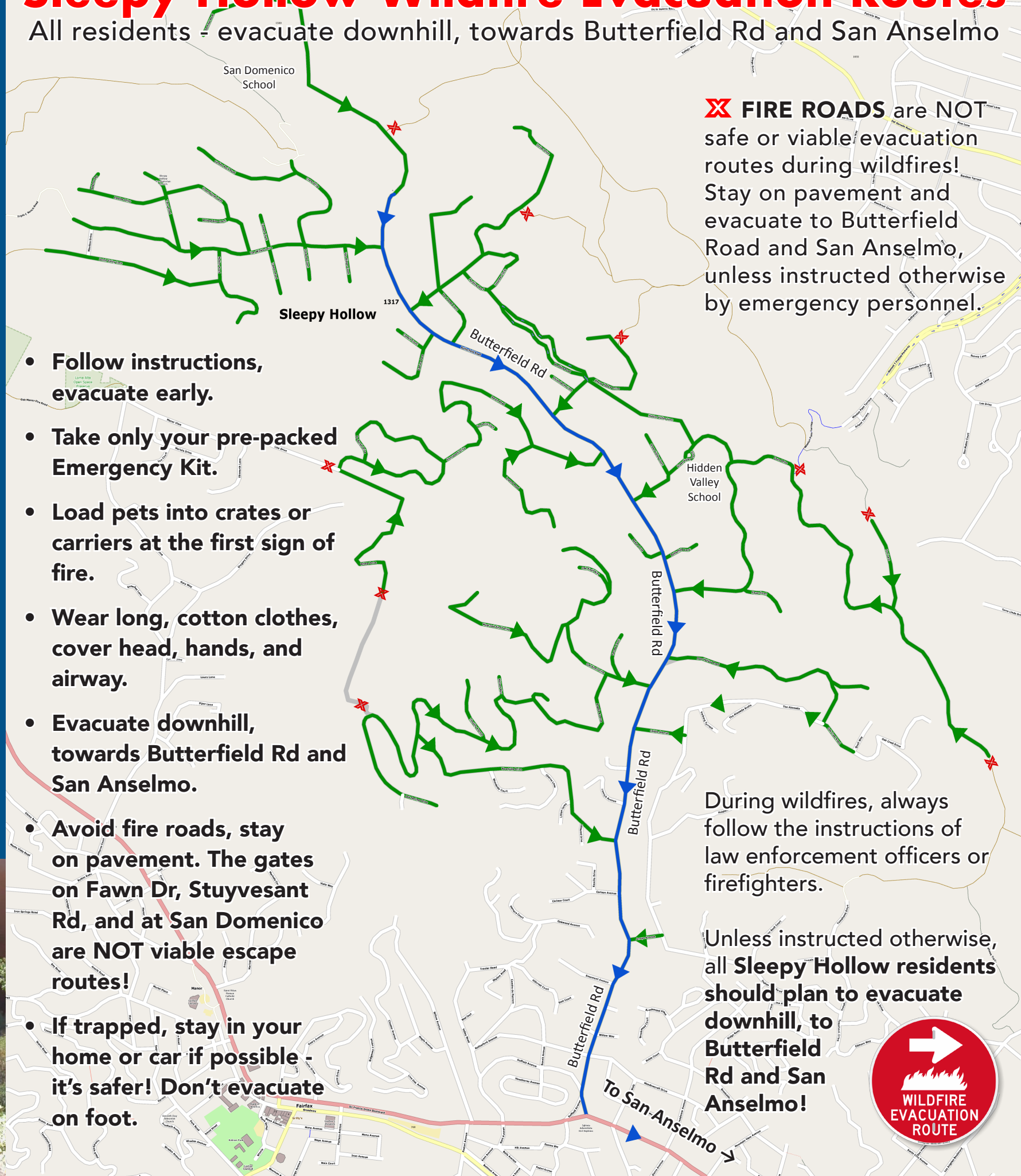

X FIRE ROADS are NOT safe or viable evacuation routes during wildfires! Stay on pavement and evacuate to Butterfield Road and San Anselmo, unless instructed otherwise by emergency personnel.

- Follow instructions, evacuate early.
- Take only your pre-packed Emergency Kit.
- Load pets into crates or carriers at the first sign of fire.
- Wear long, cotton clothes, cover head, hands, and airway.
- Evacuate downhill, towards Butterfield Rd and San Anselmo.
- Avoid fire roads, stay on pavement. The gates on Fawn Dr, Stuyvesant Rd, and at San Domenico are NOT viable escape routes!
- If trapped, stay in your home or car if possible - it's safer! Don't evacuate on foot.

During wildfires, always follow the instructions of law enforcement officers or firefighters.

Unless instructed otherwise, all Sleepy Hollow residents should plan to evacuate downhill, to Butterfield Rd and San Anselmo!



Sign Up for Emergency Alerts

All Marin and Sleepy Hollow residents should register their cell phones or VoIP phones to receive emergency alerts by call, text, email, or app from the County of Marin.

www.AlertMarin.org

The Evacuation Process

Emergency officials will determine areas to be evacuated, and routes to use, depending upon the fire's location, behavior, winds, terrain, etc. The Sheriff's Office is responsible for enforcing an evacuation order in Sleepy Hollow. Follow their directions, or the directions of firefighters, promptly.

If time allows, emergency managers will attempt to advise you of potential evacuations in advance. You must take the initiative to keep informed and aware. Listen to your radio or TV for announcements. Be sure to sign up for the Alert Marin system BEFORE a fire threatens you. You may be directed to temporary assembly areas to await transfer to a safe location.

If You Become Trapped

Wildfires are unpredictable and spread quickly. Even if you've prepared in advance, you may find yourself trapped by a wildfire. To increase your chances of survival, it is very important to remain calm and keep everyone together. The roar of a wildfire can be extremely loud and your house or car may get hot and smoky as the fire passes. Prepare yourself mentally for noise, chaos, and the natural urge to flee your house or car. You are safer INSIDE!

The most important thing to do is to choose the place from those available to you that is best able to withstand the flaming front of the fire. This may be your home, an outbuilding, a garage or shop, or even your car.

If safe evacuation is not an option, follow these steps:

Shelter In A House of Building

1. Choose a building or structure first, your car should be a second choice.
2. Close all doors and windows and leave them unlocked.
3. Close or cover outside attic, eave, and basement vents.
4. Move wheeled vehicles or equipment away from structures.
5. Shut off natural gas unless needed for running a generator.
6. Turn on & lay out garden hoses where they won't be burned.
7. If you have a wooden fence that connects to the exterior of your home, prevent flames from spreading from the fence to your house by propping open the gate.
8. Move anything that can burn at least 30' away from your home, including patio furniture and cushions, cloth awnings, portable propane tanks, plastic trash cans, and firewood.

Shelter In Your Car

1. If there is no safe building to take refuge in, park and stay in your car - it is safer than being out in the open.
2. Find a place to park that has little or no vegetation, in an outside turn if possible.
3. Turn on headlights and emergency flashers to make your car more visible through heavy smoke.
4. Close all windows and doors, shut off all air vents, and turn off the air conditioner.
5. Get below the windows, under blankets (preferably wool) and lie on the floor to shelter yourself from radiant heat.
6. Stay in the vehicle as long as possible.
7. Wait until the fire front passes and temperature has dropped outside, then get out and into a safe area that has already burned.